

0.50mm FFC/FPC ZIF Connector

MF Series 0.50mm Pitch FFC/FPC 2.0mm High ZIF Connector

PRODUCT DETAILS

Flex Connection provides a wide range of interconnect solutions utilizing the latest Flexible Flat Cable Technology and FFC/FPC Connectors. We produce standard pitch product from 0.50mm to 2.54mm with SMD and Thru Hole Options including straight and right angle options. Our product specialists will be pleased to discuss with you your individual application requirements and advise an effective solution to meet your specific needs

FEATURES



Light Weight



Extremely Thin



Quality Design



Cost-Effective

DIMENSION OUTLINE

Bottom Contact SMD

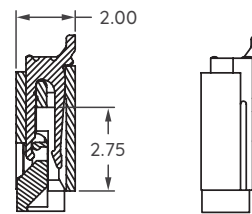
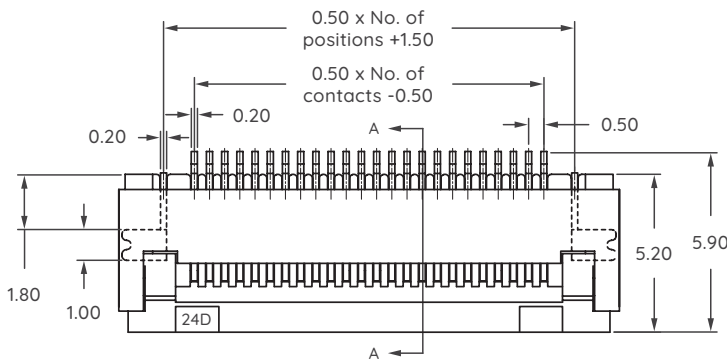

SECTION A

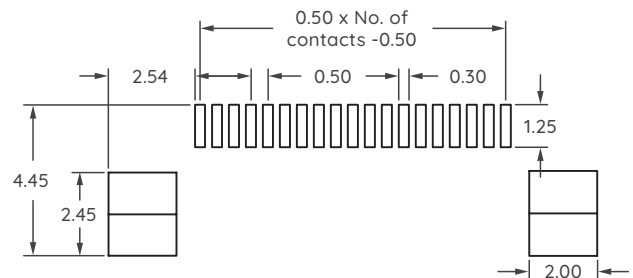
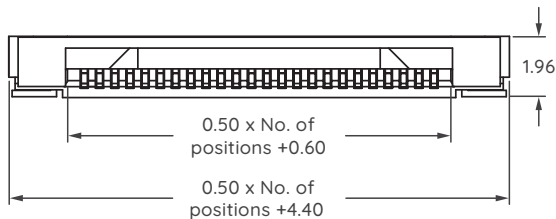

RECOMMENDED P.C.B LAYOUT
(PCB BOARD TOLERANCE ± 0.05)

ELECTRICAL AND MECHANICAL PROPERTIES

Pitch	0.50mm
Number of Conductors	4 to 60 Ways (Not Available: 23, 27, 41, 43, 53, 58, 59)
Current Rating	0.4 A
Contact Resistance	20 m Ω Max
Insulation Resistance	800 M Ω Min
Withstand Voltage	500V AC/Minute
Operation Temperature	-25°C to 85°C
Contact Material	Phosphor Bronze Tin-Plated
Insulator Material	Thermoplastic (UL94V-0) LCP +30% GF

PART NUMBERING BREAKDOWN

