

2.54mm Flat Flex Jumper Cable

HE13/HE14 Female to Female

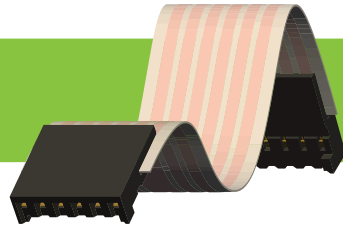







PRODUCT DETAILS

The Flex Connection range of Flat Flex Jumper Cables are manufactured with Flexible Flat Cables (FFCs) produced by laminating bare copper conductors between 2 layers of tough, flexible flame retardant UL VW-1 rated polyester insulators. We terminate either end of the Jumper Cable with connectors from leading manufacturers such as Memcon, Tyco, Nicomatic and others. Flex Connection Jumpers provide high reliability and retention compared to traditional FFCs used with ZIF/LIF products with low contact resistance and high current options while maintaining a high level of flexibility.

FEATURES

-  Highly Flexible
-  Light Weight
-  Extremely Thin
-  Quality Design
-  Suitable to Fold

APPLICATIONS

-  Domestic Appliance
-  Consumer Electronics
-  Automotive Industry
-  Medical Applications
-  Telecommunications
-  IT Equipment
-  Office Equipment
-  Robotics
-  Industrial

MATING CONNECTOR

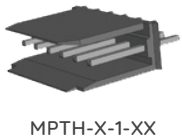

MPTH-X-1-XX

DIMENSION OUTLINE

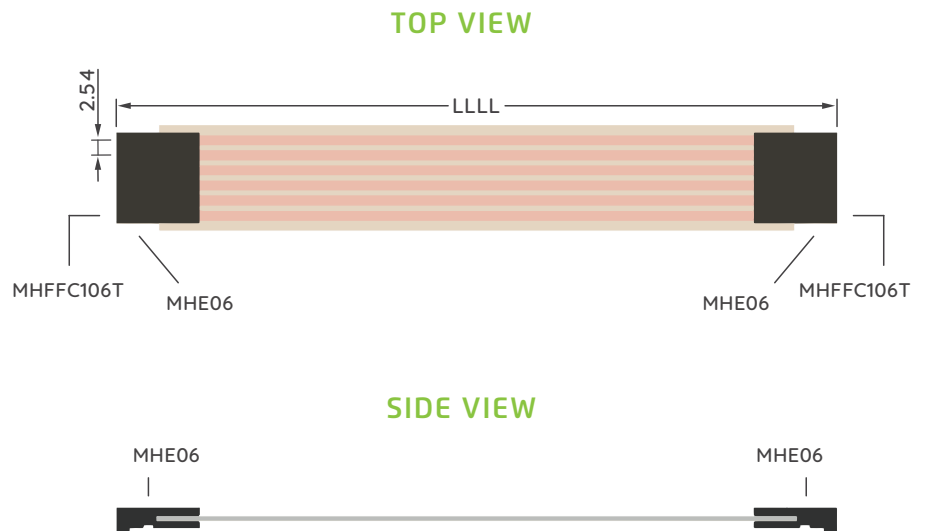

CONTACT AND HOUSING OPTIONS

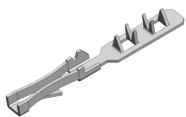

High Force Female Contact

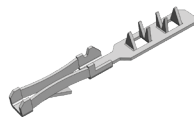

Low Force Female Contact



Full or Selective Gold Plating

ELECTRICAL AND MECHANICAL PROPERTIES

Flat Cable Material	Flat Copper Conductors laminated between 2 layers of White Polyester Insulation
Housing Style	MHE HE13/14 Housing
Housing Material	Thermoplastic with Glass Fibre UL94 VO Rated
Contact Style	MHFFC106T Hi Flex Female Contact
Contact Material	0.20mm thick Phosphor Bronze
Pitch	2.54mm
Number of Conductors	2 to 25 ways as standard
Conductor Size	1.57mm (width) x 0.076mm thick bare copper
Current Rating	3A AC / Conductor
Operating Voltage	300V RMS
Dielectric Strength	Over 1000 M Ω /M @2000VDC (20 deg C)
Resistance	<0.2 Ω /M

OTHER OPTIONS

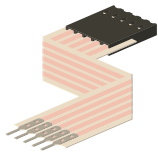

FOLDING

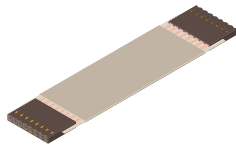

SHIELDING

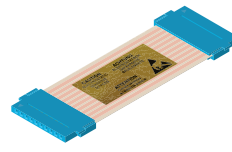

LABELING

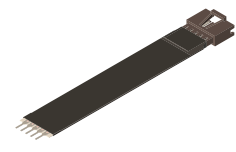

SLEEVING

PART NUMBERING BREAKDOWN

